

**HAYMAN REESE**  
PART No: **FW2280**  
**FORD RANGER MY22 – BRACKET KIT ONLY**

## INSTALLATION INSTRUCTIONS

PLEASE ENSURE THAT ALL INSTRUCTIONS ARE UNDERSTOOD PRIOR TO FITMENT  
PLACE THESE INSTRUCTIONS IN THE VEHICLE'S GLOVEBOX AFTER INSTALLATION IS COMPLETED



### Installation Instructions

**FORD RANGER MY22**

Part Number **FW2280**

Towing capacity

Max Aggregate Trailer Mass **3500 kg**

Hayman Reese (Cequent)  
PO Box 4050, Dandenong South VIC 3164  
Phone 1800 812 017 Email [info@haymanreese.com.au](mailto:info@haymanreese.com.au)

# HAYMAN REESE

PART No: FW2280

FORD RANGER MY22

## INSTALLATION INSTRUCTIONS

PLEASE ENSURE THAT ALL INSTRUCTIONS ARE UNDERSTOOD PRIOR TO FITMENT  
PLACE THESE INSTRUCTIONS IN THE VEHICLES'S GLOVEBOX AFTER INSTALLATION IS COMPLETED

### Warning:

1. Do not, drill, cut, weld or otherwise modify the rail kit.
2. If you are using electric welding on a motor vehicle, **always** check that the vehicle is not equipped with electronic engine or instrument management equipment. Failure to do so could **destroy** any onboard computers. If in doubt, check with the vehicle's manufacturer.
3. If TBM is used in inverted position tow ball may make contact with rear tailgate when lowered, which could cause damage.

### General:

1. Ensure all hardware items have been included refer to assembly diagram.
2. It is recommended that the instructions are read through and completely understood before making any attempt to fit this product.
3. Be wary of any changes to vehicle designs or other accessories that may conflict with the installation of this product.
4. Before drilling ensure that the area is clear of fuel, electrical & other components.
5. All holes drilled into the body panels shall have all burrs & swarf removed then coated with a suitable rust preventative paint.
6. The high tensile fasteners supplied with this product were used to achieve the specified rating. If replacement is required ensure that fasteners of the same rating & quality are used. Contact an authorised **Hayman Reese** dealer if further information is required.
7. Ensure that all hardware is fastened to torque listed within this document, check fasteners on regular basis.
8. Load rating sticker provided with this product shall be conspicuously located on inside rear end of the driver's door. **(See diagram below).**

### Maintenance and Care.

Hayman Reese recommends that bolt torques, as listed within this document, are routinely and regularly inspected and checked for correct tension. Replace any worn or defective parts.

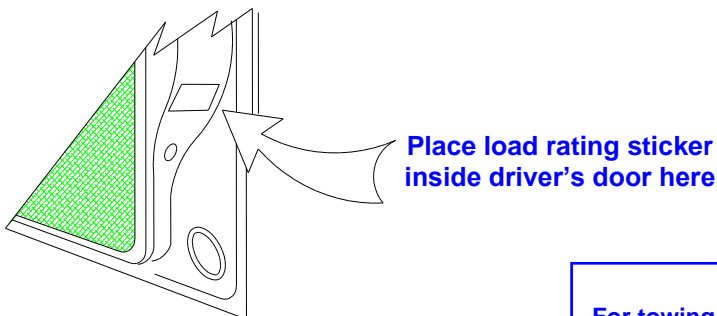

**FOR TOWING PURPOSES ONLY**  
For towing capacity details please refer to vehicle owner's manual or to the manufacturer. Overloading can void your warranties.

# HAYMAN REESE

PART No: FW2280

FORD RANGER MY22

## INSTALLATION INSTRUCTIONS

PLEASE ENSURE THAT ALL INSTRUCTIONS ARE UNDERSTOOD PRIOR TO FITMENT  
PLACE THESE INSTRUCTIONS IN THE VEHICLES'S GLOVEBOX AFTER INSTALLATION IS COMPLETED

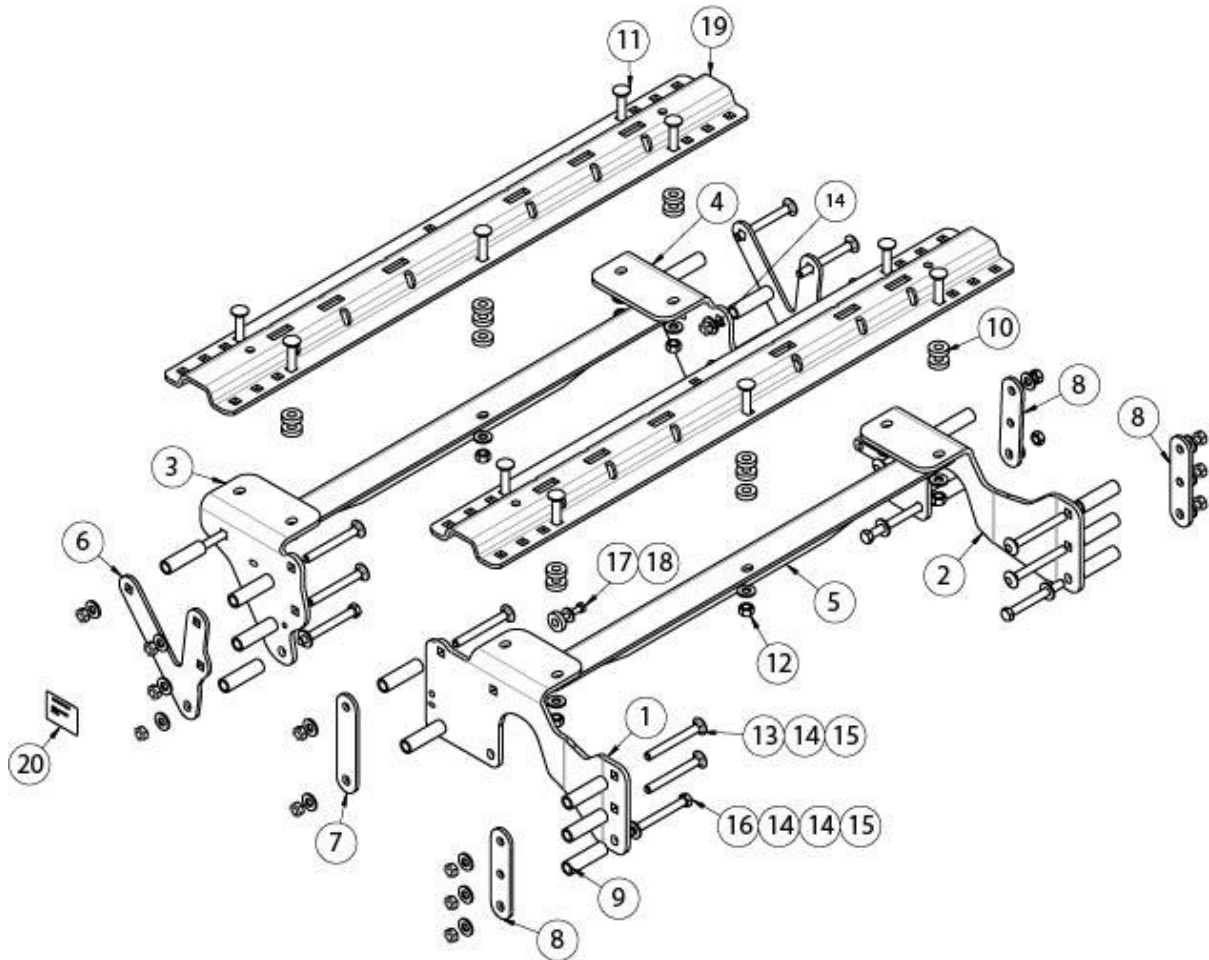

ITEM	DESCRIPTION	QTY
1	REAR MOUNT BRK LHS	1
2	REAR MOUNT BRK RHS	1
3	FRONT MOUNTING BRK LHS	1
4	FRONT MOUNTING BRK RHS	1
5	CROSS BRACE BRK	2
6	CLAMPING PLATE1	2
7	CLAMPING PLATE2	1
8	CLAMPING PLATE3	3
9	CRUSH TUBE1	18
10	SPACER	23

ITEM	DESCRIPTION	QTY
11	COACH BOLT 1/2x2 1/2 UNC	10
12	NUT HEX HD 1/2" UNC	10
13	COACH BOLT M12x110x8.8P	12
14	WASHER PLAIN M12x27x3.0	34
15	NUT NYLOC INS HEX M12x1.75	18
16	BOLT HEX HD M12x110x1.75P	6
17	BOLT HEX HD M8x40x1.25P	1
18	WASHER PLAIN M8x22x3	1
19	BASE-RAIL	2
20	COMPLIANCE LABEL	1

# HAYMAN REESE

PART No: FW2280

FORD RANGER MY22

## INSTALLATION INSTRUCTIONS

PLEASE ENSURE THAT ALL INSTRUCTIONS ARE UNDERSTOOD PRIOR TO FITMENT  
PLACE THESE INSTRUCTIONS IN THE VEHICLES'S GLOVEBOX AFTER INSTALLATION IS COMPLETED

### KITS OPTION

**For 30123 - Euro hitch kit.  
Follow the below instruction.**

**For DPGP01 - Goose plate kit.  
Follow the below instruction.**

**For 101407 / 9464-AUS - Hide A  
Goose kit.  
Refer to FW2287 kit instruction.**

1. Prior to installation, ensure that vehicle's handbrake is engaged.  
Open the bonnet and remove the (-) negative terminal from the vehicle battery.

Remove spare wheel.

2. Remove the main harness earth terminal and 1x fir tree clip from the chassis.

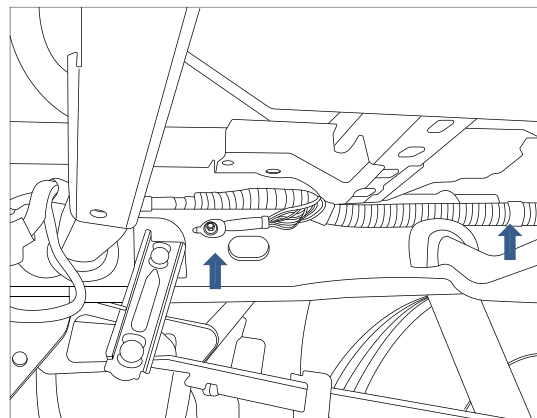

# HAYMAN REESE

PART No: FW2280

FORD RANGER MY22

## INSTALLATION INSTRUCTIONS

PLEASE ENSURE THAT ALL INSTRUCTIONS ARE UNDERSTOOD PRIOR TO FITMENT

PLACE THESE INSTRUCTIONS IN THE VEHICLES'S GLOVEBOX AFTER INSTALLATION IS COMPLETED

- Slide the harness connector out of the fir tree clip on the outer face of the chassis near the spring hanger.

Repeat for the other side.

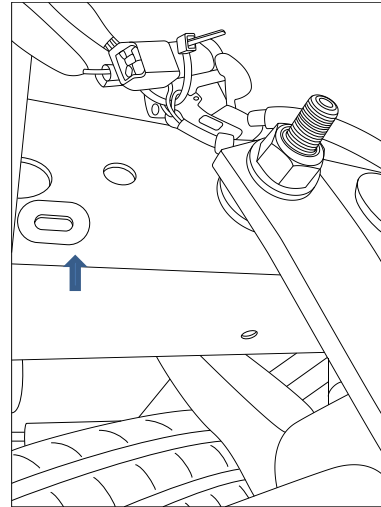

- Remove 1x M8 bolts on the brake line bracket and 1x fir tree clip from the chassis. Remove 4x harness fir tree clips from the chassis. Remove 1x hose clips from the chassis.

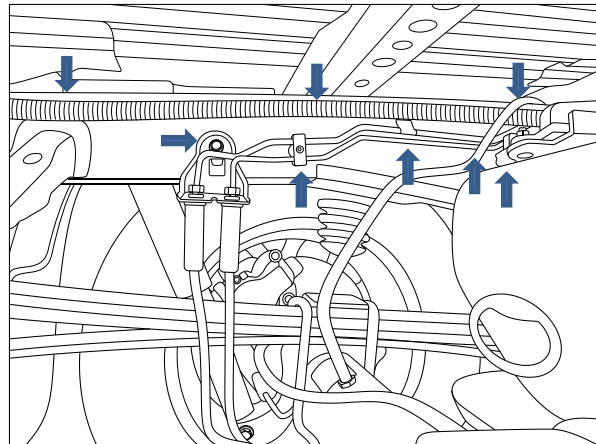

- Remove 1x harness fir tree clip from the chassis.
- Remove 4x screws and the heat shield from the tub.

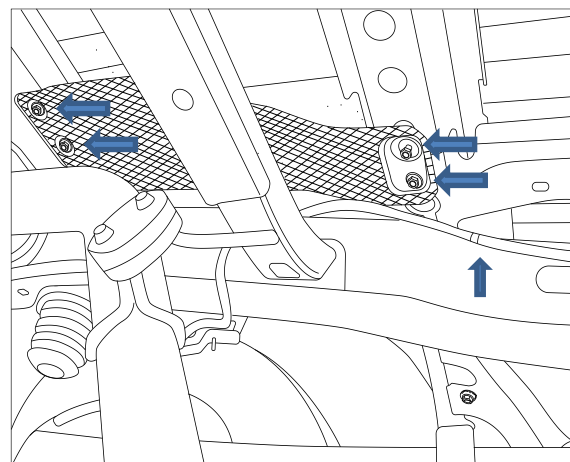

# HAYMAN REESE

PART No: FW2280

FORD RANGER MY22

## INSTALLATION INSTRUCTIONS

PLEASE ENSURE THAT ALL INSTRUCTIONS ARE UNDERSTOOD PRIOR TO FITMENT

PLACE THESE INSTRUCTIONS IN THE VEHICLES'S GLOVEBOX AFTER INSTALLATION IS COMPLETED

7. Use a sheet metal nibbler cutter to cut out the area.  
Spray some cold galvanise around the cut-out area for surface protection.

Repeat for the other side.



**NOTE:**

Move any harness clear away from any cutting blade.

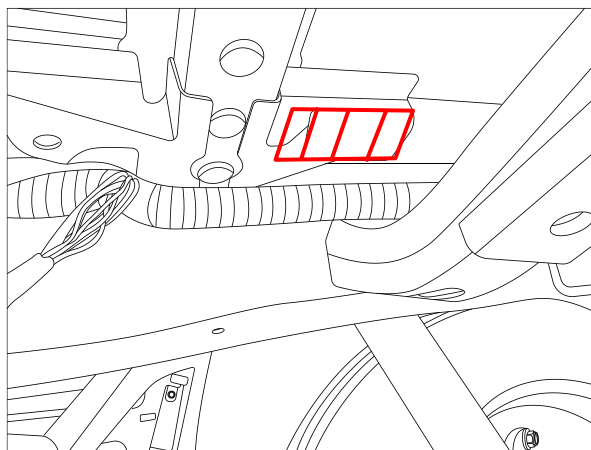

8. Use the hole in the chassis where brake line bracket to locate the rear bracket.  
Fit the LHS Rear mounting bracket to the chassis and loosely secure it with a M8 bolt.
9. Loosely secure the rear mounting bracket with 3x M12 coach bolts, 3x crush tubes, 2x side plates, 3x washers and 3x lock nuts to chassis.
10. Place and loosely secure the bottom slots holes in the rear mounting bracket and the slots in the side plates with 2x hex bolts, 2x crush tubes, 4x washers and 2x nuts.



**NOTE:**

Make sure that no harnesses, brake line and rubber tube are clamped between the mounting brackets, side plates and chassis.

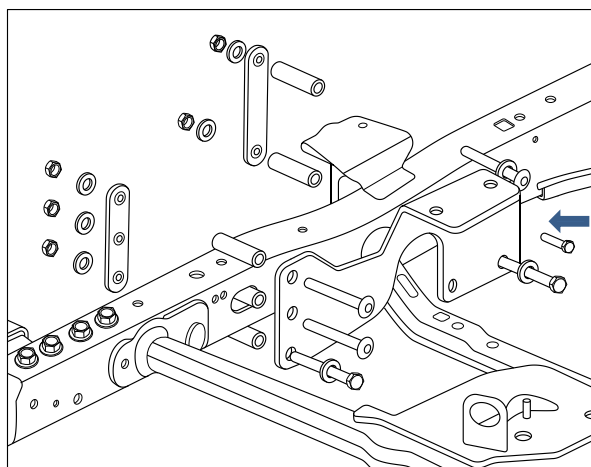

11. Use the hole in the chassis to locate the rear bracket.  
Place and align the RHS Rear mounting bracket to the chassis hole (symmetrically opposite to the brake line bracket hole).
12. Loosely secure the rear mounting bracket with 3x M12 coach bolts, 3x crush tubes, 2x side plates, 3x washers and 3x lock nuts to chassis
13. Place and loosely secure the bottom slots holes in the rear mounting bracket and the slots in the side plates with 2x hex bolts, 2x crush tubes, 4x washers and 2x nuts.



**NOTE:**

Make sure that no harnesses, brake line and rubber tube are clamped between the mounting brackets, side plates and chassis.

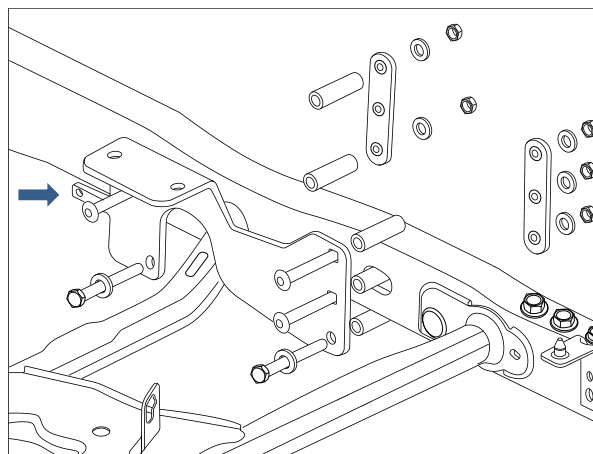

# HAYMAN REESE

PART No: FW2280

FORD RANGER MY22

## INSTALLATION INSTRUCTIONS

PLEASE ENSURE THAT ALL INSTRUCTIONS ARE UNDERSTOOD PRIOR TO FITMENT

PLACE THESE INSTRUCTIONS IN THE VEHICLES'S GLOVEBOX AFTER INSTALLATION IS COMPLETED

14. Place and align the LHS Front mounting bracket hole to the chassis hole.
15. Loosely secure the rear mounting bracket with 3x M12 coach bolts, 3x crush tubes, 1x V-plates, 3x washers and 3x lock nuts to chassis.
16. Place and loosely secure the bottom slots holes in the LHS front mounting bracket and the slots in the side plate with 1x hex bolt, 1x crush tubes, 2x washers and 1x nuts.



**NOTE:**

Make sure that no harnesses, brake line and rubber tube are clamped between the mounting brackets, side plates and chassis.

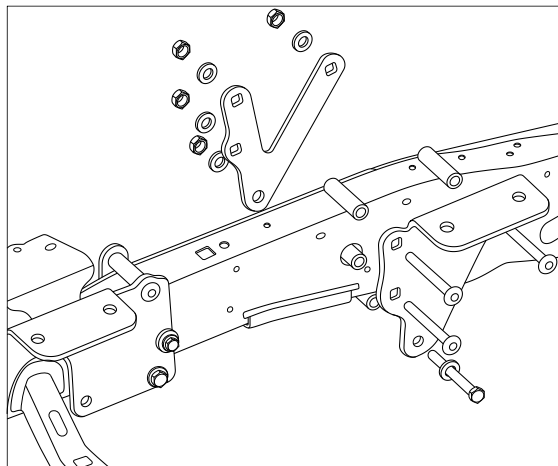

17. Place and align the RHS Front mounting bracket hole to the chassis hole.
18. Place the V-plate to the chassis and slide the V-plate above the shock bracket and then place a coach bolt into the top square hole of the V-plate
19. Loosely secure the RHS front mounting bracket with 2x M12 coach bolts, 3x crush tubes, 1x plates, 3x washers and 3x lock nuts to chassis.
20. Place and loosely secure the bottom slots holes in the RHS front mounting bracket and the slots in the side plate with 1x hex bolt, 1x crush tubes, 2x washers and 1x nuts.



**NOTE:**

Make sure that no harnesses, brake line and rubber tube are clamped between the mounting brackets, side plates and chassis.

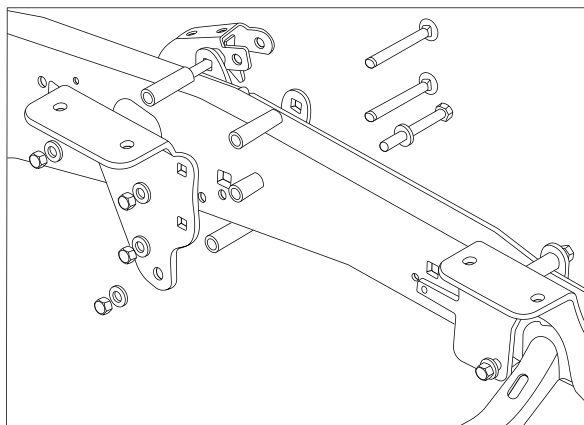

21. Under the tub, Drill 2x 3mm pilot holes at the slots center of the RHS rear mounting bracket.

Repeat for the LHS rear mounting bracket.

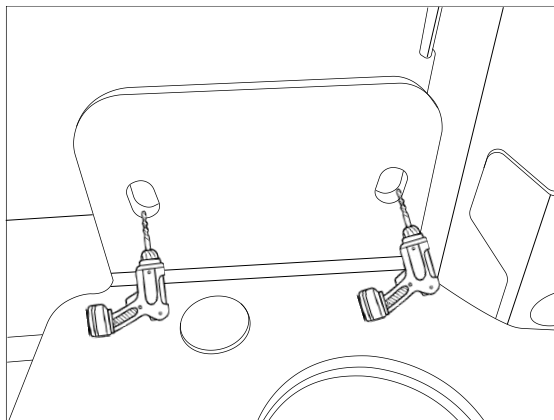

# HAYMAN REESE

PART No: FW2280

FORD RANGER MY22

## INSTALLATION INSTRUCTIONS

PLEASE ENSURE THAT ALL INSTRUCTIONS ARE UNDERSTOOD PRIOR TO FITMENT

PLACE THESE INSTRUCTIONS IN THE VEHICLES'S GLOVEBOX AFTER INSTALLATION IS COMPLETED

22. From the top of the tub, use a 38mm hole saw to drill through 4x pilot holes from previous step.

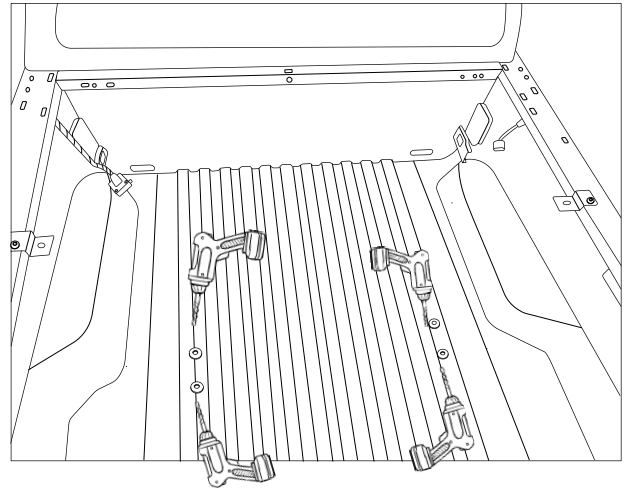

23. Place the 1<sup>st</sup> Base-rail (from FW2280 bracket kit) on the tub and align the 4x Base-rail square holes with the 4x slots in the LHS – RHS rear mounting brackets. Secure the 4x coach in the Bas-rail to prevent it from moving.
24. Place the 2<sup>nd</sup> Base-rail on the tub. The offset distance between the Base-rail is about 415mm.

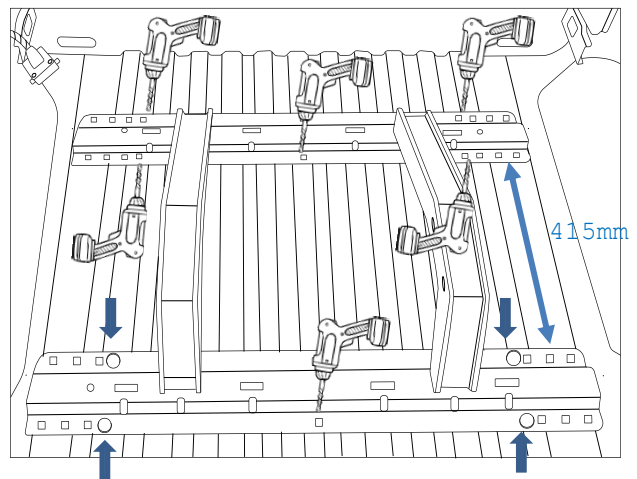

### **For 30123 - Euro hitch kit**

Use 2x legs to offset the base rail. Push the 2x base-rail together to prevent any rattling

### **For DPGP01- Goose plate kit**

Use the Goose plate to offset the base rail. Push the 2x base-rail together to prevent any rattling.

25. Mark and drill 6x pilot holes in the center of the Base rail square holes.

26. Check the pilot holes are near the slots center of the LHS – RHS front mounting brackets.

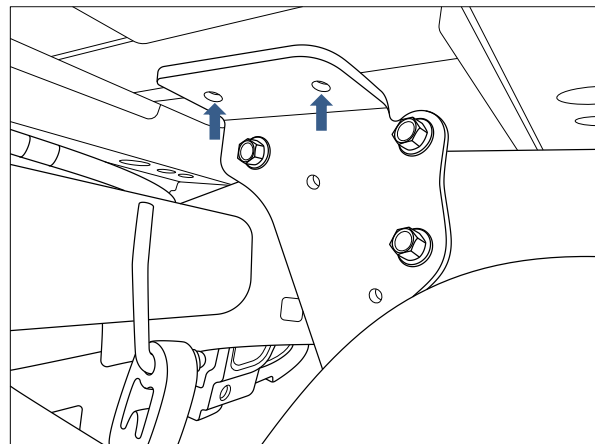



# HAYMAN REESE

PART No: FW2280

FORD RANGER MY22

## INSTALLATION INSTRUCTIONS

PLEASE ENSURE THAT ALL INSTRUCTIONS ARE UNDERSTOOD PRIOR TO FITMENT

PLACE THESE INSTRUCTIONS IN THE VEHICLES'S GLOVEBOX AFTER INSTALLATION IS COMPLETED

27. Remove the 4x coach bolts, 2x Base-rail and 2x high-level legs.
28. Use a 38mm hole saw to drill through 6x pilot holes from previous step.
29. Spray some cold galvanise around the cut-out holes for surface protection.
30. Place 2x spacers on each slot of the mounting bracket.

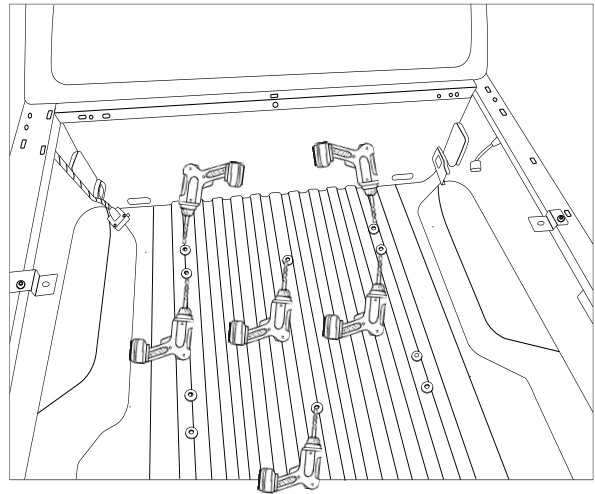

31. Place and align the 2x Base-rail on the spaces.
32. Place 5x coach bolts into each Base-rail.

**Note: The low-level legs are optional and for illustrative purposes only**

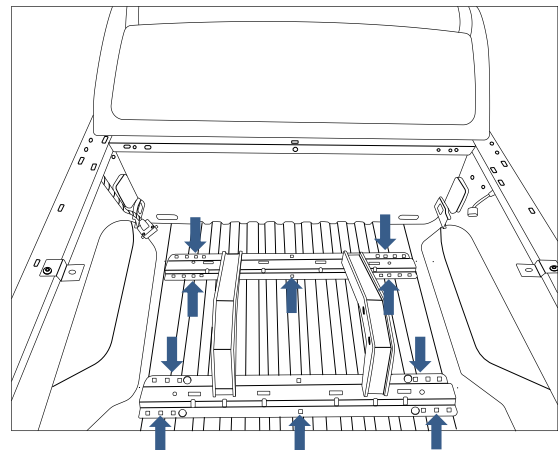

33. Place 1x washer and 1x lock nut in the most forward hole, of the vehicle, of the front bracket.
34. **Torque** the coach bolts and hex bolt in the LHS Front mounting bracket as specified below.

Repeat for the other side.

Torques:

1/2" Coach Bolts: 77Nm



### **NOTE:**

Make sure torque the 1/2" Coach Bolts before the move on to the next step.

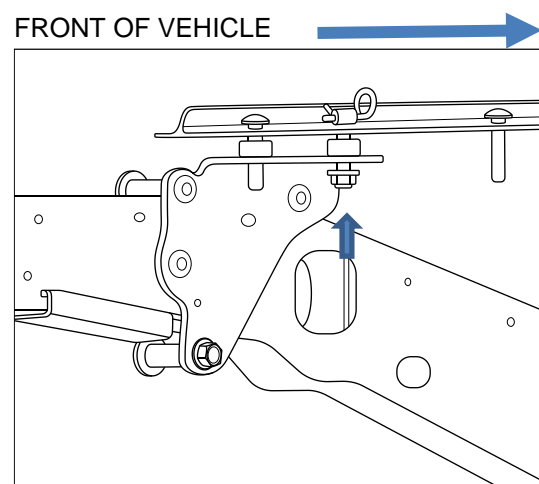

# HAYMAN REESE

PART No: FW2280

FORD RANGER MY22

## INSTALLATION INSTRUCTIONS

PLEASE ENSURE THAT ALL INSTRUCTIONS ARE UNDERSTOOD PRIOR TO FITMENT

PLACE THESE INSTRUCTIONS IN THE VEHICLE'S GLOVEBOX AFTER INSTALLATION IS COMPLETED

35. Place 3x spaces the middle rail coach bolt.
36. Place the cross bracket under the tub and secure it with 3x washer and 3x lock nuts.

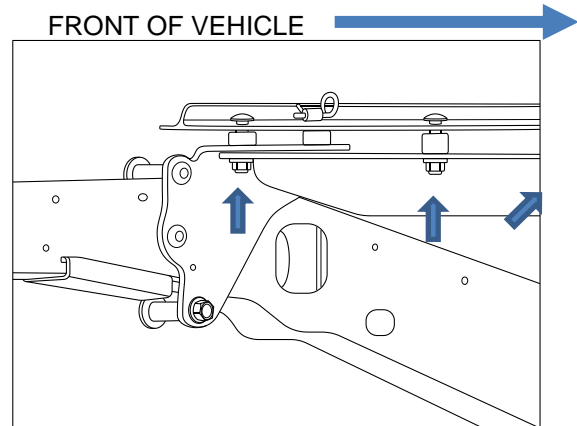

37. Repeat step 33 – 36 for the Rear mounting brackets.
38. Torques the fasteners as following:

**Torques:**

**M12 Coarse: 77Nm**

**1/2" Coach Bolts: 77Nm**

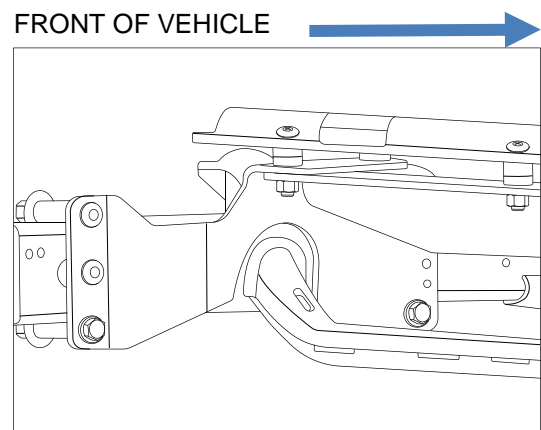

39. Place a spacer between the LHS Rear mounting bracket and brake lining bracket. Secure the brake lining bracket with a supplied M8 bolt. Refit the brake lining plastic clip, the rubber tube clip and the harness clips.

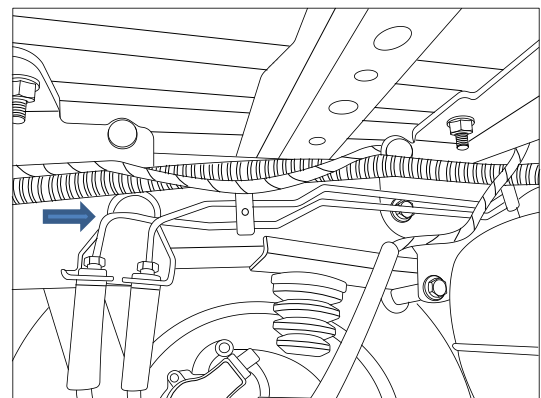

# HAYMAN REESE

PART No: FW2280

FORD RANGER MY22

## INSTALLATION INSTRUCTIONS

PLEASE ENSURE THAT ALL INSTRUCTIONS ARE UNDERSTOOD PRIOR TO FITMENT

PLACE THESE INSTRUCTIONS IN THE VEHICLES'S GLOVEBOX AFTER INSTALLATION IS COMPLETED

40. Fit the below kits as require.

- For 30123 - Euro hitch kit.  
Refer to the kit instruction.
- For DPGP01- Goose plate kit.  
Refer to the kit instruction.



41. Feed the 3m tail harness (part No 04938) into the tub cut-out.
42. Route and cable tie the harness, under the tub, along the side of the chassis rail main harness.
43. Connect the tail harness (part no 04968) and route along the tow bar.

**Note:**

Check with the vehicle user manual for the cable routing guidelines.

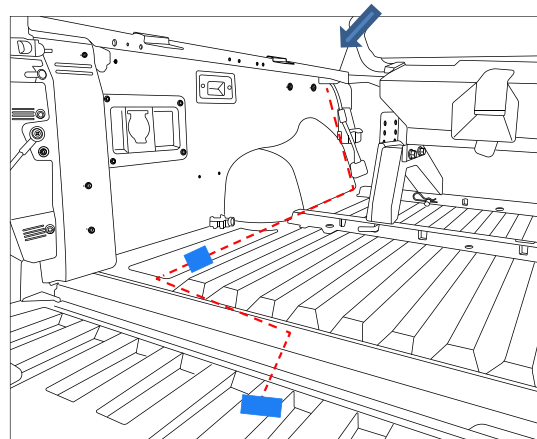

44. Remove 2x screw from the plug bracket.
45. Place the plug plate between the plug and the tow bar bracket. Secure it with 2x removed screws.
46. Place the dummy socket under the plug plate. Secure it with 2x new screws, 2x washer and 2x lock nuts.

